

+ + + + =

Computers

[2018-19]

Q Tick the correct option:

VEDANT PUBLIC SCHOOL PRIMARY

1. A Computer is an _____ machine.

a. electronic b. mechanical c. none of these
2. Computer are used in _____

a. sleeping b. Schools c. Swimming
3. It is smaller than a Computer.

a. L.E.D b. T.V c. Calculator
4. Computer works _____

a. Speedily b. Slowly c. medium
5. Who does not make mistakes?

a. man b. Computer c. none of these
6. The most popular Computer is also known as _____

a. DC b. BC c. PC
7. The Computer can be small, medium or large in size and is usually placed on a desk is known as _____

a. Desktop Computer b. Laptop Computer c. Super Computer
8. Which of the following has a touch screen interface?

a. Super Computer b. Tablet c. Desktop Computer

427
421 427
5715

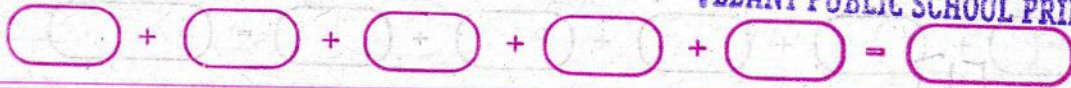

9. Which of the following is a wireless Computer?

- a. Desktop
- b. Super
- c. Laptop

10. It can be taken along with you.

- a. Tablet
- b. Desktop Computer
- c. Super Computer

11. They are generally smaller than laptop Computers and extremely light weight and can easily fit into a briefcase is known as _____

- a. Tablet
- b. Notebook Computers
- c. Desktop Computers

12. Who needs rest after work and gets tired?

- a. man
- b. Computer
- c. none of those

13. The word 'computer' has come from the word _____

- a. Comp
- b. Comput
- c. Compute

14. The full form of P.C is _____

- a. Pan Computer
- b. Personal Computer
- c. Picture Computer

15. Which of the following is not a Personal Computer?

- a. Super Computer
- b. Laptop Computer
- c. Desktop Computer

Q2. Fill in the blanks

smaller, continuously, feelings, electronic, human being, desktop, Personal Computer, net book, Laptop, Super Computer.

$$\text{○} + \text{○} + \text{○} + \text{○} + \text{○} = \text{○}$$

1. A Computer is an electronic machine.
2. Computer that are placed on a desk are called desktop Computer.
3. A Computer can work continuously.
4. PC stands for Personal Computer.
5. A human being is slow in doing calculations.
6. Super Computer are the fastest type of Computers.
7. A Computer has no feelings.
8. The Computers that are smaller and lighter than Notebook Computers are called netbook.
9. A Calculator is smaller than a Computer.
10. A Laptop can fit in your lap and is larger than Notebook Computers.

Q3. Write 'True' or 'False'

1. A Computer cannot work continuously. False.
2. A tablet is a wireless Computer. True
3. A Computer has no intelligence. True
4. You can carry a laptop anywhere. True
5. The word 'Computer' comes from the word 'data'. False
6. A Computer can think on its own. False
7. A mainframe Computer is a small Computer. False
8. A human being does not make mistakes. False
9. A PC looks like a small briefcase. False.
10. Notebook Computers are smaller than laptop Computers. True

પરન
પેરિ પરન
ક્રમિસ

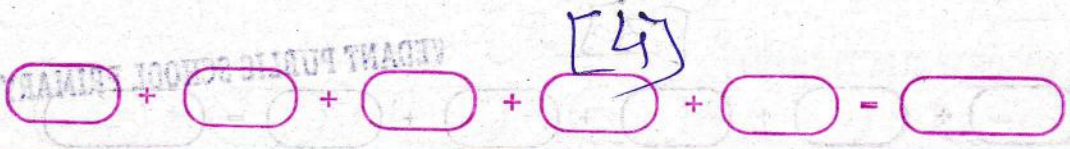

VEDANT PUBLIC SCHOOL PRIMARY

Q4. Missing

1. C o m p u t e r
2. B a n k
3. E l e c t r o n i c
4. S h o p
5. L a p t o p
6. T a b l e t
7. N o t e b o o k
8. D e s k t o p
9. M a i n f r a m e
10. M a n

Q5. Matching

Tablet

Computer desktop

Laptop

Calculator

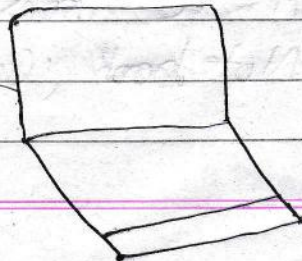
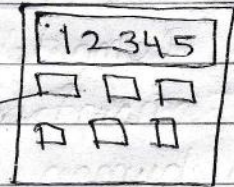
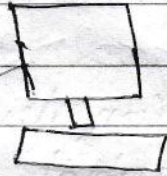

VEDANT PUBLIC SCHOOL PRIMARY

[4]

પ્રશ્ન
પેરિ પ્રશ્ન
ક્રમ

[5]

$\bigcirc + \bigcirc + \bigcirc + \bigcirc + \bigcirc = \bigcirc$

School



Hospital

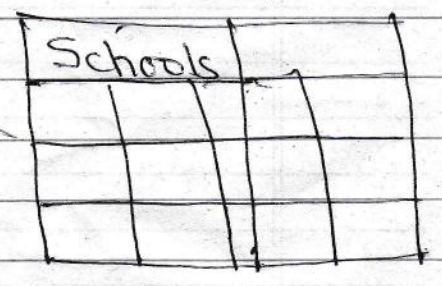

Pencil

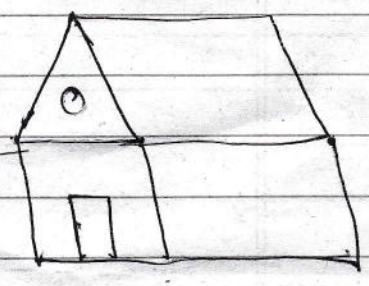

Home

